

2



1

STEP-1:

UNPACK YOUR LADDER

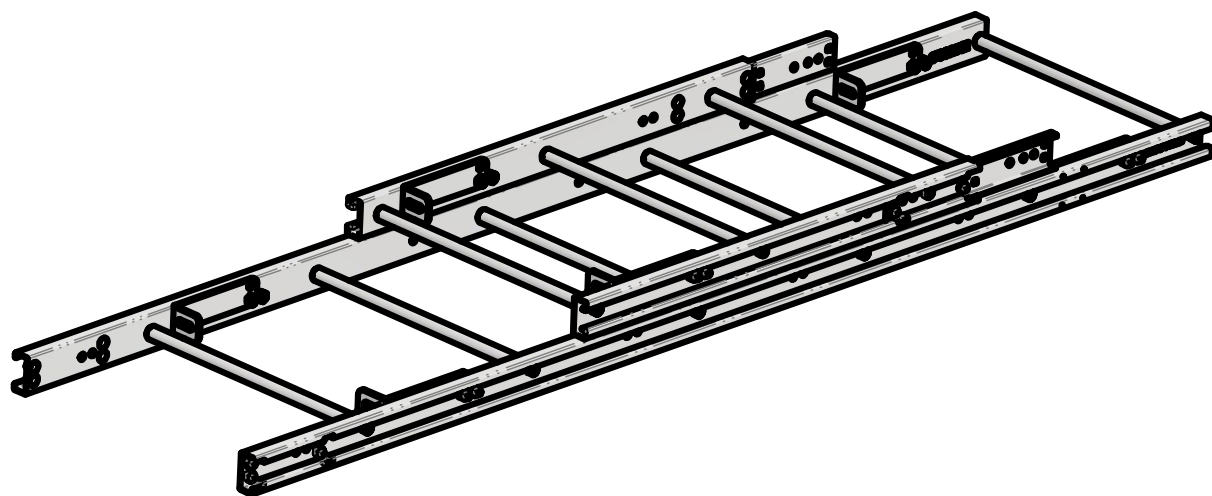

B

B

A

A

2



1

2



1

STEP-2:

SEPARATE THE TOP PIECE FROM THE BOTTOM PIECE

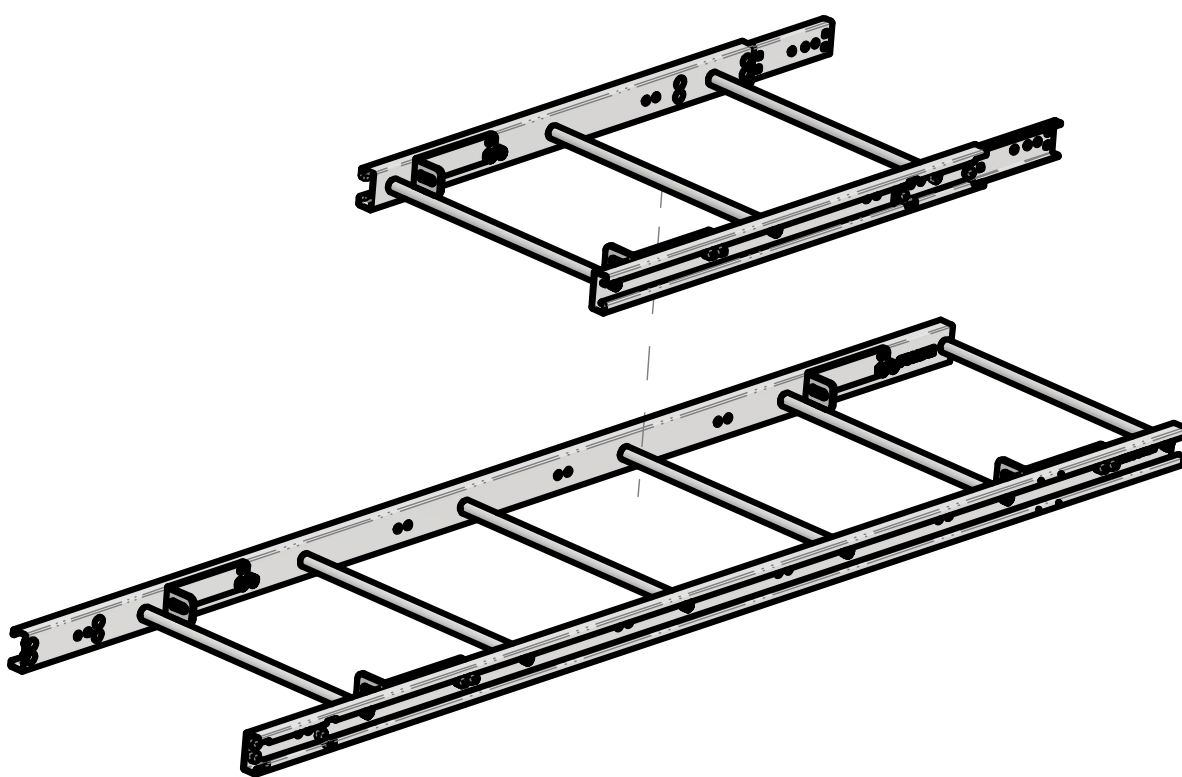

2



1

2



1

STEP-3:

ATTACH BOTTOM AND TOP PIECES

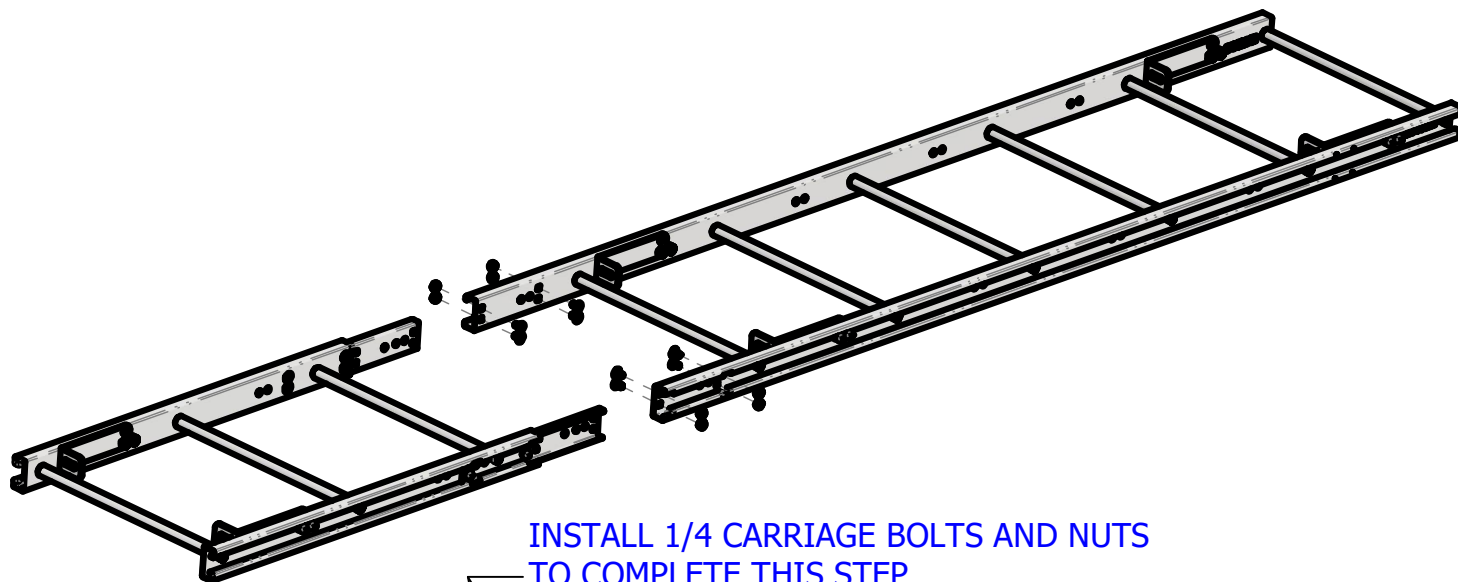

INSTALL 1/4 CARRIAGE BOLTS AND NUTS
TO COMPLETE THIS STEP
(BOLTS AND NUTS ARE PRE-POSITIONED IN THE HOLES)

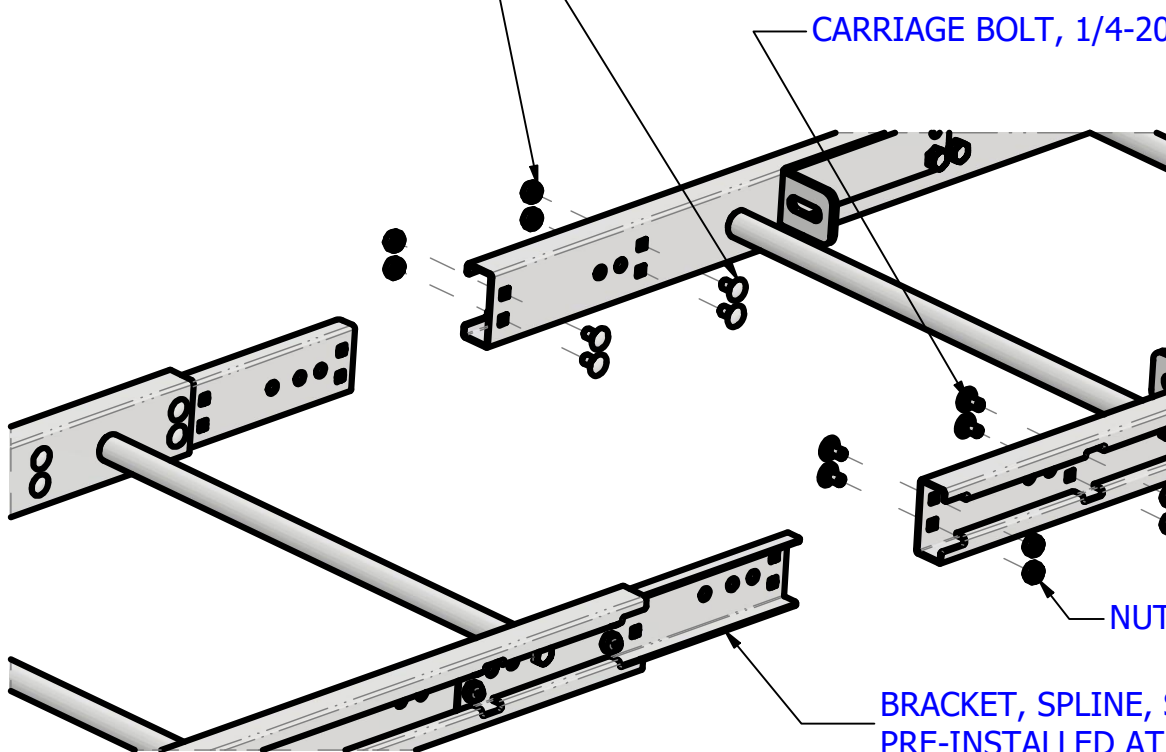

CARRIAGE BOLT, 1/4-20 X 1/2 LG., STZ

NUT, HEX, 1/4-20, STZ

BRACKET, SPLINE, S2-CLIMBER
PRE-INSTALLED AT FACTORY

2



1

STEP-4:

SEPARATE BOTTOM AND TOP PIECES

- REMOVE 1/4-20 WALL BRACKET BOLT
- ROTATE BRACKET 90 DEGREES
- RE-SECURE USING THE SAME BOLT
- (BRACKET WAS ROTATED 90 DEGREES FOR SHIPPING)

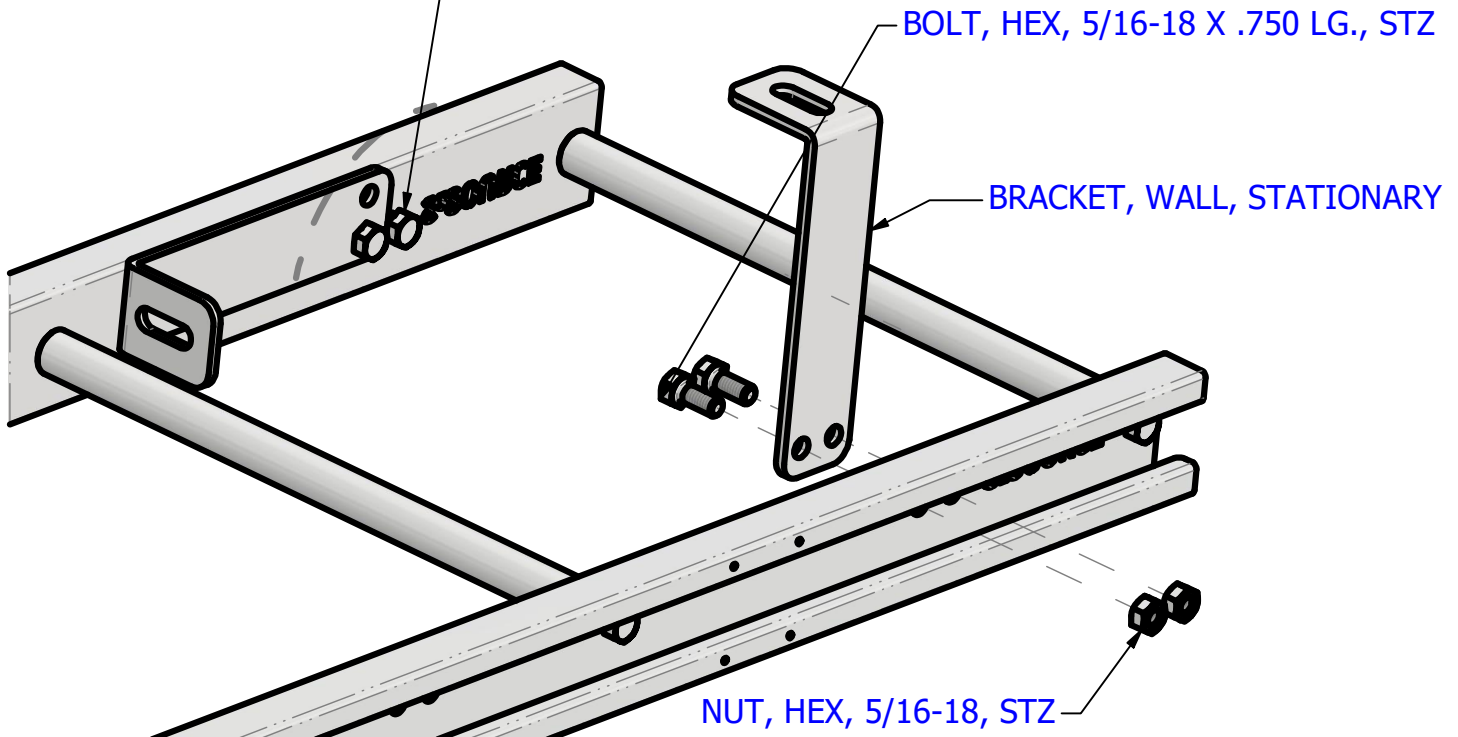

OVERALL PARTS LIST

